

**STBG**

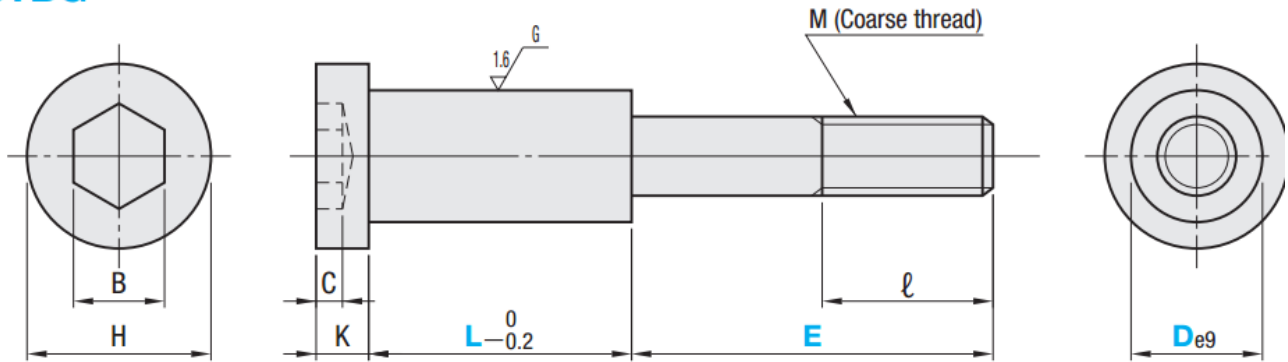

**M** SCM435  
**H** 33~38HRC

C	K	H	B	M	ℓ	Part Number		L	E						
						Type	D								
4	8	16	6	6	17	STBG	10	10	19	24					
								15	19	24	29				
								20	19	24	29	34			
4	8	18	8	8	20		13	10	22	27					
								15	22	27	32	37			
								20	22	27	32	37	42		
							25		27	32	37	42	42		
							30		27	32	37	42	42	47	
7	13	24	10	10	23		16	10	30	35					
								15	30	35	40				
								20	30	35	40	45			
								25	30	35	40	45	50		
								30		35	40	45	50	55	
9	13	27	14	12	26		20	15	38	43					
								20	38	43	48				
						25		38	43	48	53				
						30				48	53	58			
						35				48	53	58			
10	18	33	17	16	32	25	15	44	49						
							20		49	54	59				
							25		49	54	59				
							30		49	54	59	64			
							40			54	59	64	69		



Part Number L - E  
**STBG10 L13 - E27**