

D	M	H
4~8	SKD11	60~63HRC
10~50	SUJ2	58HRC~ (Induction hardening)

AP

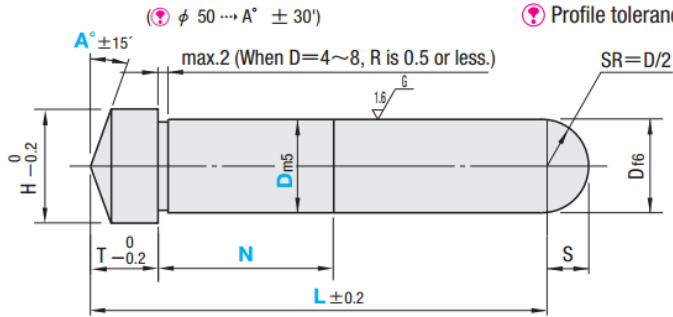

0.3

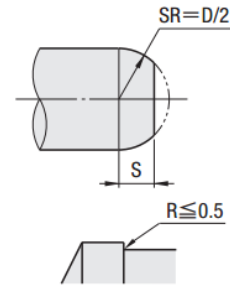

- When D=25 or more, the pin tip becomes as shown in the drawing on the left.
- D ≥ 25时 球面端以左图为准。
- When D=4~8, R is 0.5 or less.
- D=4~8时 肩部根部为 R ≤ 0.5的圆角。

Machining may leave a chuck keyhole on one end of the pin in case of D=20 or 25. Dimensions of the pins with chuck keyholes are values prior to machining of the holes. In case of D=30 or more, the both ends may have chuck keyholes.
D=20·25时, 有时一端带有中心孔, 此时斜导柱的各尺寸为中心孔加工前的尺寸。D>30时, 两端带中心孔。

APS (Stepped type)

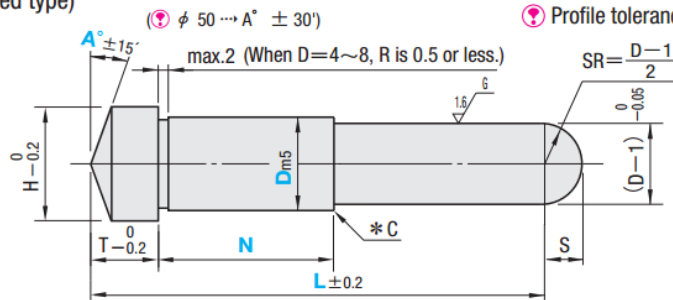

0.3

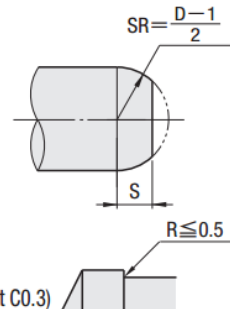

- When D=25 or more, the pin tip becomes as shown in the drawing on the left.
- D ≥ 25时 球面端以左图为准。
- When D=4~8, R is 0.5 or less.
- D=4~8时 肩部根部为 R ≤ 0.5的圆角。

*For D4~25, C-chamfering is performed on the edges of the steps. (Recess of C-chamfering for assembling: about C0.3)
Machining may leave a chuck keyhole on one end of the pin in case of D=20 or 25. Dimensions of the pins with chuck keyholes are values prior to machining of the holes. In case of D=30 or more, the both ends may have chuck keyholes.

* D4~25的台阶周边作了倒角C加工。(倒角C约0.3)

D=20·25时, 有时一端带有中心孔, 此时斜导柱的各尺寸为中心孔加工前的尺寸。D>30时, 两端带中心孔。



Part Number - D - L - N

AP - D16 - L150 - N50

D	m5	f6 (AP)	T	H	S		Part Number		0.1mm increments		A 1° increments
					AP	APS	Type	D	L	N	
4	+0.009 +0.004	-0.010 -0.018	5	7	2	1.5	AP	4	15.0~70.0 70.1~90.0	$2 \leq N$ $N \leq L - T - 1$ or $N = 0$ (No press-fit section)	0~30
5				8	2.5	2		5	15.0~70.0 70.1~90.0 90.1~100.0		
6				9	3	2.5		6	15.0~70.0 70.1~90.0 90.1~110.0		
8	+0.012 +0.006	-0.013 -0.022	10	11	4	3.5		8	15.0~80.0 80.1~110.0 110.1~130.0		
10				13	5	4.5		10	20.0~110.0 110.1~160.0 160.1~200.0		
12	+0.015 +0.007	-0.016 -0.027	13	15	6	5.5		12	20.0~110.0 110.1~160.0 160.1~200.0 200.1~250.0		
13				16	6.5	6		13	20.0~110.0 110.1~160.0 160.1~200.0 200.1~250.0		
15				18	7.5	7		15	20.0~110.0 110.1~160.0 160.1~200.0 200.1~250.0		
16	+0.017 +0.008	-0.020 -0.033	15	19	8	7.5		16	20.0~110.0 110.1~160.0 160.1~200.0 200.1~250.0		
20				23	9.5	20		40.0~130.0 130.1~200.0 200.1~300.0 300.1~350.0			
25				28	10	25		40.0~130.0 130.1~200.0 200.1~300.0 300.1~350.0 350.1~400.0			
30	+0.020 +0.009	-0.025 -0.041	15	35	10	10		30	60.0~160.0 160.1~220.0 220.1~300.0 300.1~400.0 400.1~500.0		
32				37				32	70.0~160.0 160.1~220.0 220.1~300.0 300.1~400.0 400.1~500.0		
35				40				35	100.0~160.0 160.1~220.0 220.1~300.0 300.1~400.0 400.1~500.0		
40	+0.020 +0.009	-0.025 -0.041	15	45	10	10		40	100.0~160.0 160.1~220.0 220.1~300.0 300.1~400.0 400.1~500.0		
50				20			55	50	200.0~260.0 260.1~320.0 320.1~400.0 400.1~500.0		