

鑽石修刀 / Diamond Dressing Tools

單石修刀 / Single Point Diamond Dressers

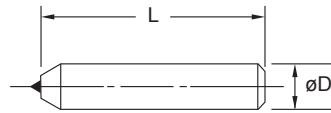

訂購時請說明編號及鐵柄尺寸或提供詳細圖面

When ordering, please specify order no. & shank size or detail drawing.

鑽石番號 Dia. wt. code	大約重量(克拉) Approx. wt.(cts.)	編號 Order no.	適用砂輪 Grinding wheels size(mm)
#5	0.18	DS005	Ø150x25以下 or smaller
#10	0.20	DS010	
#15	0.25	DS015	
#20	0.35	DS020	Ø150~Ø300x25
#25	0.50	DS025	
#33	0.75	DS033	
#50	1.0	DS050	Ø300~Ø450x25~40
#75	1.5	DS075	Ø450~Ø600x50~100
#100	2.0	DS100	Ø600以上/or larger.

正確安裝及使用 / Installation and operation

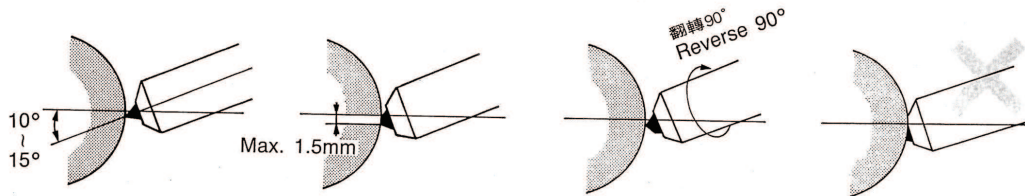

多石修刀 / Multi Point Diamond Dressers

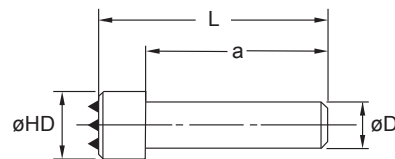

訂購時請說明編號及鐵柄尺寸或提供詳細圖面

When ordering, please specify order no. & shank size or detail drawing.

總鑽石重量 Total stone weight	鑽石顆數 Nos.of stone	鑽石層數 Nos.of stone layer	編號 Order no.
1.0 Carat	3	1	DM03201
1.0 Carat	5	1	DM05101
1.0 Carat	6	1	DM06101
1.4 Carat	7	1	DM07101
0.6 Carat	3	1	DM03101

成型修刀 / Diamond Forming Dressers

成型修刀 / Chisel Type Diamond Dressers



■ 成型修刀用於砂輪之成形修整，或內、外弧之成形修整。
For forming accurate radii and forms on grinding wheels.

鑽石角度 (V°)	鑽石端弧度 (R)	鑽石原料 Diamond material	編號 Order no.
55°	0.2 R	天然鑽石 Nature Diamond	DF0255
60°	0.5 R		DF0560
55°	0.2 R	人造鑽石 Synthetic Diamond	DF0255F
60°	0.5 R		DF0560F

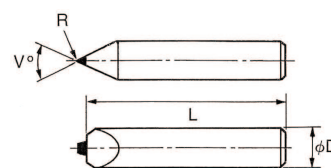

訂購時請說明編號及鐵柄尺寸或提供詳細圖面。

When ordering, please specify order no. & shank size or detail drawing.

圓錐修刀 / Coned Diamond Dressers



■ 圓錐修刀用於砂輪之成形修整，或內、外弧之成形修整。
For forming accurate radii and forms on grinding wheels.

鑽石角度 (V°)	鑽石端弧度 (R)	鑽石原料 Diamond material	編號 Order no.
60°	0.02~0.03R	Ø1/8" x 1" L	DC600
60°	0.02~0.03R	Ø1/8" x 2" L	DC601
60°	0.02~0.03R	Ø1/4" x 2" L	DC602
60°	0.02~0.03R	Ø3/8" x 2" L	DC603
60°	0.02~0.03R	Ø10 x 50L(mm)	DC604

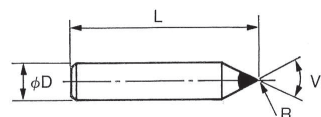

CVD 成型修刀 / CVD Forming Dressers

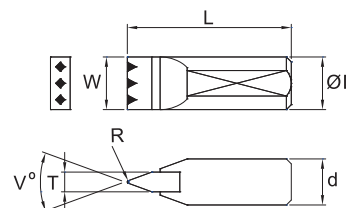
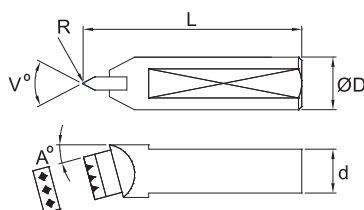

V°	A°	W	R	øD	d	L	鑽石顆數 Stone nos.	編號 Order no.
40	-	8	0.2	8	-	25	3	CVD-F0240-1
55	-	10	0.2	12	11	40	3	CVD-F0255-1
55	15	10	0.2	12	10	50	3	CVD-F02550-T1
55	6	10	0.2	12	11.5	50	3	CVD-F02550-T2

其他規格請提供詳細圖面訂購。

Other size, please offer detail drawing to order.

結合修刀 / Impregnated Diamond Dressers



鑽石齒塊尺寸 / The dimensions of diamond tips

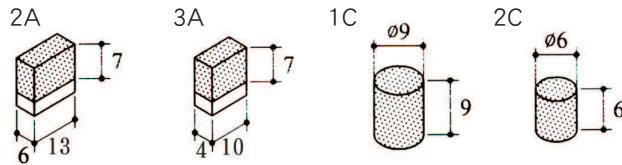

單位 / Unit : mm

編號 Order no.	鑽石齒塊 Diamond tips	粒度 Grit size	鐵柄形狀 Type of shank	鐵柄尺寸 Size of shank	適用範圍 Applications
DI-2AFC	2A	F		Ø12x100L	無心研磨,圓筒研磨,平面研磨 砂輪尺寸 Ø300x25 到 Ø500x63 For centerless, cylindrical, surface grinding. Wheel size : Ø300x25 to Ø500x63
DI-2AMC	2A	M		Ø12x50L	
DI-2ARC	2A	R		Ø11x30L	
DI-2AFD	2A	F		Ø12x50L	
DI-2AMD	2A	M		Ø11x30L	
DI-2ARD	2A	R			
DI-1CFG	1C	F		Ø12x50L	一般用途之研磨 砂輪尺寸Ø300或以下 For general purpose grinding. Wheel size: Ø300and smaller.
DI-1CMG	1C	M		Ø11x30L	
DI-1CRG	1C	R			

粒度 / Grit size : F : 細目 / Fine M : 中目 / Medium R : 粗目 / Coarse

手持式鑽石修刀 / Hand Diamond Dressers



鑽石齒塊尺寸 / The dimensions of diamond tips

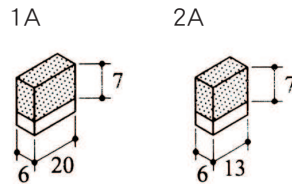

單位 / Unit : mm

形式 Form	編號 Order no.	鑽石齒塊 Diamond tips	粒度 Grit size
Type 01 總長 / Total length : 160mm	HD-01R HD-01F	 2A	R: 粗目/Coarse F: 細目/Fine
Type 02 總長 / Total length : 200 mm 方向 ① Direction ① 或 or 方向 ② Direction ②	HD-02R HD-02F	 1A	R: 粗目/Coarse F: 細目/Fine