

Catalog No.	Components						
	①	②	③	④	⑤	⑥	
RBSH	MRP	MBB LBB	MBSH	SWP	-	-	
RMSH	BRPM				MBJH	STM	-
RKSH	BRPK					-	STK
QBSH	MRP		MBS			STM	-
QMSH	BRPM				SWP	-	STK
QKSH	BRPK					STM	-
RB	MRP	MBB LBB	MBS	SWP		-	-
RM	BRPM				MBJ	STM	-
RK	BRPK					-	STK
QB	MRP		MBSH			STM	-
QM	BRPM				MBJH	-	STK
QK	BRPK					STM	-

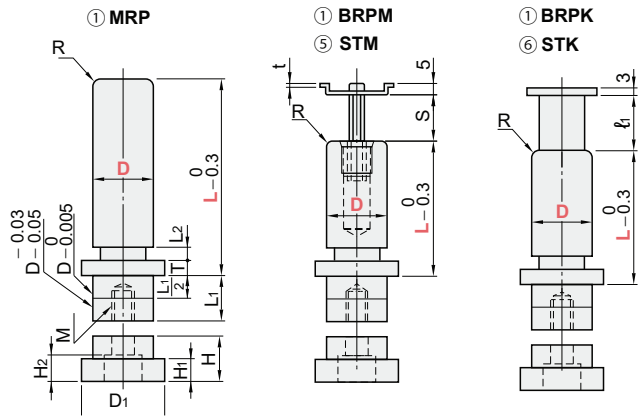

② MBB

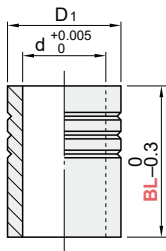

② LBB

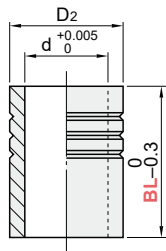

③ MBSH
MBS

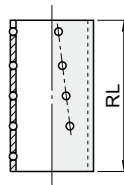

③ MBJH
MBJ

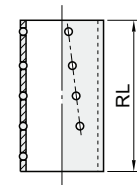

④ SWP

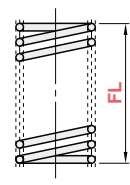

MRP · BRPM · BRPK												
D	D1	L1	L2	H	H1	H2	T	t	M	R	Provided bolt	
20	+0.020	28	15	10	14	7	8.5	5	1.6	8 x 8	2.0	CB 8-25
22	+0.015	30	16									
25		35	18									
28	+0.025	36	20	12	16	8	10.5	10	2.0	10 x 22	3.5	CB 10-30
32	+0.020	40	23									
38	+0.030	49	27									
45	+0.025	55	32	15	18	10	12.5	12	2.0	12 x 27	4.0	CB 12-35
50	+0.035	62	35									
50	+0.030	72	42									

MBB · LBB				
d	D1 · D2	D1	D2	
26	37	+0.5	-0.007	0
28	40			
31	45			
36	50	+0.3	-0.008	0
40	55			
48	64			
55	74	0	-0.010	0
60	83			
70	95			

RL	S	ℓ1
50	0 ~ 19	15
60	0 ~ 23	20
75	0 ~ 30	25
90	0 ~ 37	30
110	0 ~ 47	35

Type	M	H	S
MRP BRPM BRPK	M SUJ2 H 58HRC~ (induction hardening)	M S45C(Cap)	
STM	M S45C S Black oxide (Fe ₃ O ₄)		
STK	M S45C S Black oxide (Fe ₃ O ₄)	Accessories CB	

Type	M	H
MBB LBB	M SUJ2 H 58HRC~	
MBSH MBS	M A5056 (Aluminum)	

Type	M
MBJH MBJ	M Polyacetal resin (POM)
SWP	M SWP-B

Type	D	L								② MBB LBB		RL	FL 10mm increments		
										Type	BL				
RBSH RMSH RKSH QBSH QMSH QKSH RB RM RK QB QM QK	20	80	90	100	110	120					M (MBB)	50	50	40 ~ 140	
	22	80	90	100	110	120						50	50	40 ~ 140	
												60	60		
	25	80	90	100	110	120	130						60	60	40 ~ 150
													80	75	
	28	100	110	120	130	140	150	160					60	60	50 ~ 150
											80		75		
	32	120	130	140	150	160						80	75	70 ~ 190	
												100	90		
	38	140	150	160	170	180						80	75	80 ~ 190	
												100	90		
	45	140	150	160	170	180						100	90	80 ~ 190	
120												110			
50	160	170	180	200							100	90	80 ~ 190		
											120	110			
60	160	170	180	200							100	90	80 ~ 190		
											120	110			



Order Example

TYPE	D	L	② Type	FL
RBSH38	-	180	-	L100 - FL120