

51100 PFA > Punch Former

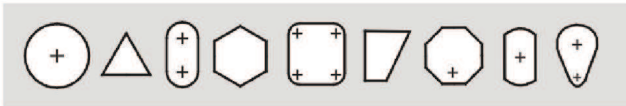

N.W. 8.6kg



Punch Forming Applications



Wheel Dressing Applications

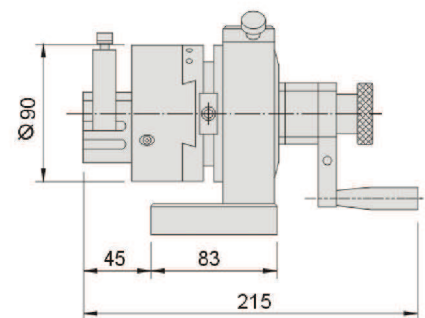
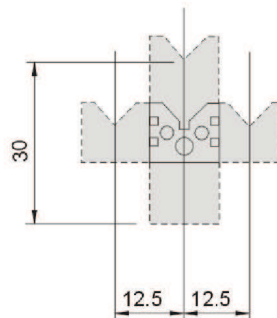
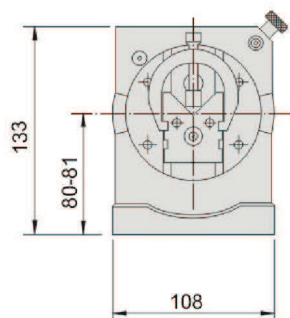
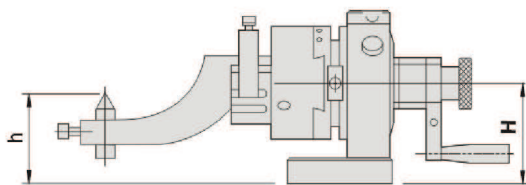

Features :

- ▶ PFA Punch Former is suitable for applying on surface grinding machine and processing various shapes of Punches.
- ▶ Due to its vertical & horizontal adjustment function, it is specially suitable for oval punch grinding.
- ▶ Adopting Arc attachment for dressing wheels in various shapes.
- ▶ Depending on different outer dia. of the workpieces, V-block is necessarily adjusted in order to make center accuracy within 0.005mm

Main parameters:

- Center height 80 ~ 81mm
- Clamping dia. range of V-block $\varnothing 4 \sim 30$ mm
- Travel of V-block 30mm
- Slide plate horizontal movement ± 12.5 mm
- Indexer tooth q'ty & accuracy $24, 15^\circ \pm 10''$
- Clamping accuracy (50mm) 0.005mm
- Capable wheel size of dressing $\varnothing 200$ mm
- Max. radius when dressing arc
- Convex R48mm
- Concave R100mm

Calculation Formula:

- Dressing convex arc $h=H-R$
- Dressing concave arc $h=H+R$
- h: distance from tip of diamond to base of Punch Former
- H: Center height of Punch Former
- R: Radius of the arc to be dress