

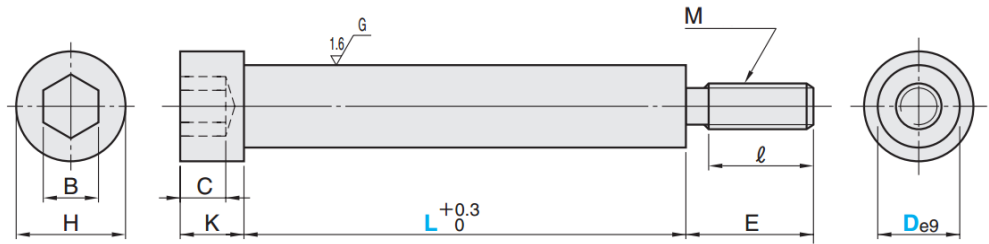

PBTX



M SCM435
H 33~38HRC

C	K	H	B	E	M	ℓ (Reference)	Part Number		L
							Type	D	
4	8	16	6	19	M 6	17	PBTX	10	100 110 120
									130 140 150
4	8	18	8	22	M 8	20		13	100 110 120
									130 140 150
								160 170 180	190 200
7	13	24	10	30	M10	23		16	100 110 120
									130 140 150
								160 170 180	190 200
9	13	27	14	38	M12	26	20	140 150	
								160 170 180	
								190 200	
								210 220 230 240 250 260	
								280 300	
10	18	33	17	44	M16	32	25	170 180	
								190 200	
								210 220	
								230 240	
								250 260	
								280 300	
								320	
350									



Part Number L
PBTX16 L220