

**MS** (Straight type)

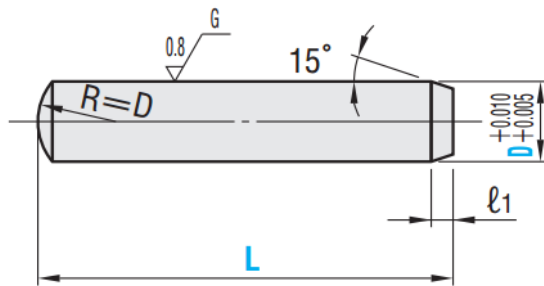

**M** 52100  
**H** 58HRC~

$\ell_1$	Catalog No.		L		
	Type	D			
0.4	MS	1	6 8 10		
0.6		1.5	6 8 10		
1.0		2		10 15	
				6 8 20	
		2.5	6 8 10 15 20		
1.5		3		6 25 30	
				10 15 20 25 30 35 40	
		4	8 10 15 20 25 30 35 40 45 50		
2.0		5		8 35 40 45 50	
				15 20 25 30	
		6	8 10 35 40 45 50 55 60		
2.5		8		30 40 50	
				10 15 20 25 35 45 55 60 65 70 80	
	10	40 50 60			
3.0	12		15 20 25 30 35 45 55 65 70 80		
			40 50 60		
	13	20 25 30 35 45 55 70 80			
3.5		40 50 60 70 80			

**MSTP** (Tapped precision type)

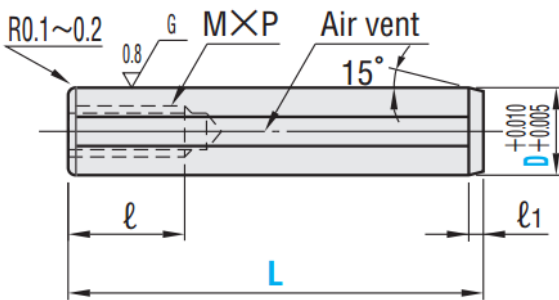

⚠ If L dimension is 10 with D5•6, the pilot hole for the tap may go all the way through.

**M** 52100  
**H** 58HRC~

$\ell_1$	$\frac{M}{P}$	$\ell$	D	Catalog No.		L	
				Type	D		
1.5	$\frac{3}{0.5}$	*6	$\pm 0.010$ $\pm 0.005$	MSTP	5	10 15 20 25 30	
					6	10 15 20 25 35 40 50	
2.0	$\frac{4}{0.7}$	*8			8	15 20 25 35 40 45 50 60 70 80	
					10	15 20 25 30 35 40 45 50 60 70 80	
2.5	$\frac{5}{0.8}$	10			12	20 30 40 50 60 70 80	
					13	40 50 60 70 80	
					16	40 50 60 70 80	

⚠ \* If D=5, then  $\ell=6$  is a value for reference only.

⚠ \* Only if D=6 and L=10, then  $\ell=6$ .