

l_4	l_3	l_2	l_1	d_5	d_4	d_3	d_2	d	s	l	Order No.		
2.5	3.5	9	16	2	4	2	4	10	2,6	0,3	100	Z962/10/ 2,6x0,3x100	
											200	10/ 2,6x0,3x200	
											100	10/ 3 x0,3x100	
						3	2,4	5	3	4	0,5	200	10/ 3 x0,3x200
												100	10/ 4 x0,5x100
												200	10/ 4 x0,5x200
	4,5	18	6	4	8	12	5	160	12/ 5 x0,5x160				
								315	12/ 5 x0,5x315				
								160	16/ 6 x0,5x160				
								315	16/ 6 x0,5x315				
								160	16/ 6 x0,5x160				
								315	16/ 6 x0,5x315				
6	7	5	12	16	6	160	18/ 8 x1 x160						
						315	18/ 8 x1 x315						
						160	20/10 x1 x160						
7	8	10	20	8	8	315	20/10 x1 x315						
						160	25/12 x1 x160						
						315	25/12 x1 x315						
8	10	20	25	10	12	160	25/12 x1 x160						
						315	25/12 x1 x315						
						315	25/12 x1 x315						

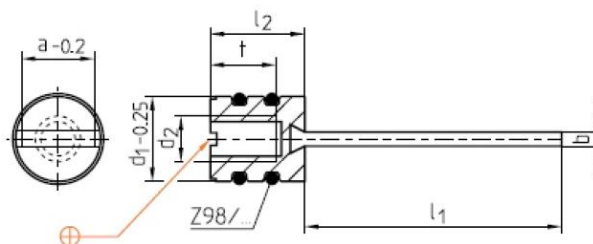

Z98/...	max. °C	l_2	t	d_2	d_2	b	a	l_1	Order No.
Z98/ 9,5x1,5	135	13	10	M6	11,9	1,5	8	180	Z965/1,5x08x180
							10		10x180
Z98/11,8x2,4		16	11,5	M8	15,8	1,8	12	250	Z965/1,8x12x250
							15		15x250

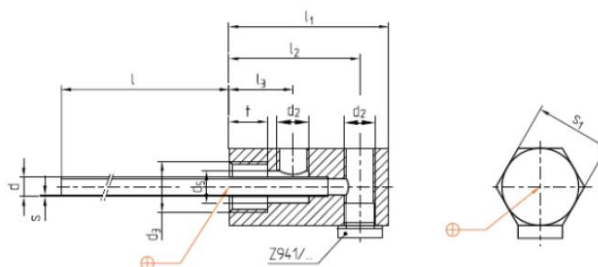

s_1	t	d_5	d_3	d_2	l_3	l_2	l_1	Typ	d	s	l	Order No.
24	12	10	M16x1,5	M10x1	20	41	50	13	6	0,5	400	Z97/13/6x0,5x400
32	18	14	M24x1,5	M14x1,5	26,5	51,5	63	19	8		630	19/8x0,5x630