

SW	l ₁	l ₂	l	d ₂	d ₁	d ₃	α	Order No.
17	16,5	22,5	34,5	6	9	M14x1,5	45°	Z876/ 9/14x1,5/45
						G1/4		9/R1/4 /45
22	14	28	35,5	9	13	M16x1,5		Z876/13/16x1,5/45
						G3/8		13/R3/8 /45

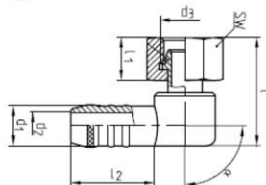

SW	l ₁	l ₂	l	d ₂	d ₁	d ₃	α	Order No.
17	16,5	22,5	34,5	6	9	M14x1,5	90°	Z876/ 9/14x1,5/90
						G1/4		9/R1/4 /90
22	14	28	35,5	9	13	M16x1,5		Z876/13/16x1,5/90
						G3/8		13/R3/8 /90

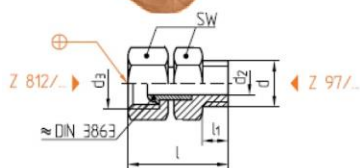

SW	l ₁	l	d ₂	d ₃	Typ	d	Order No.
22	9	35	9	M16x1,5	13	M16x1,5	Z877/13/16x1,5
30	16	62	13	M24x1,5	19	M24x1,5	19/24x1,5

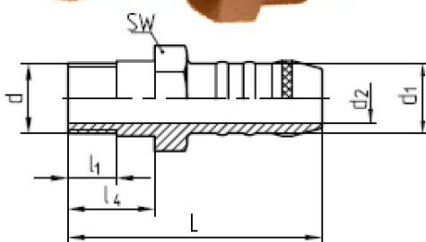
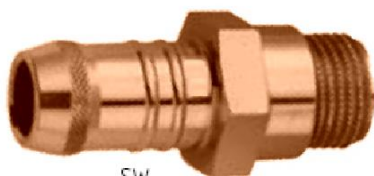

SW	L	l ₁	l ₄	d ₂	d ₁	d	Order No.
11	40,5	7	14	6	9	M10x1	Z88/ 9/10x1
						G1/8A	9/R1/8
15	47	9	16	8	13	M12x1,5	13/12x1,5
						M14x1,5	13/14x1,5
						G1/4A	13/R1/8
27	62	12	22	13	19	M24x1,5	Z88/19/24x1,5
						G1/2A	19/R1/2