

Part Number	M	H
LBPS	SKS3	53~56HRC
LBPM	HPM2T equivalent	37~41HRC

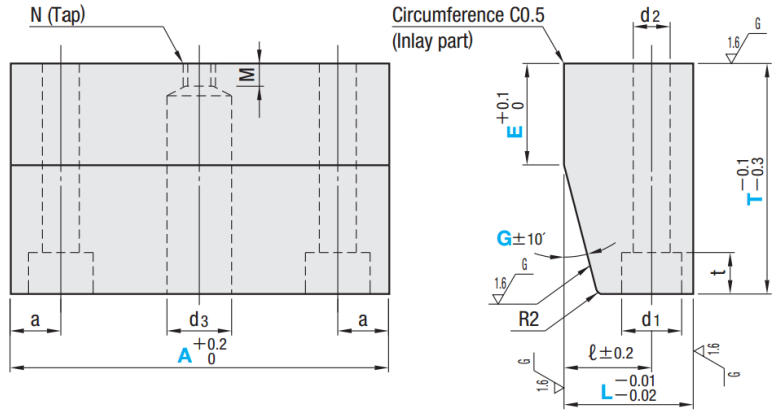

● This locking block can be easily removed by inserting a bolt and jacking up as shown in the figure.

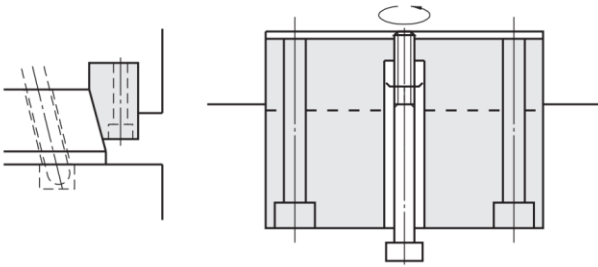

Tap N	M	a	ℓ	d1	d2	d3	t	Part Number		T	A	E 1mm increments	G° 1° increments
								Type	L				
M5	5	8	14	9.5	5.5	9.5	6	LBPS (SKS3)	20	30	33 38 48 58	10~12	5~22
												13~15	5~25
												16~18	5~29
												19~20	5~33
												10~12	5~17
												13~15	5~19
												16~18	5~22
												19~20	5~26
												10~12	5~13
												13~15	5~16
												16~18	5~18
												19~20	5~20
M6	6	10	18	11.5	6.5	11	7	LBPM (HPM2T equivalent)	25	35	38 48 58 68 78	12	5~26
												13~15	5~27
												16~18	5~30
												19~20	5~33
												12	5~21
												13~15	5~22
												16~18	5~25
												19~20	5~28
												12~15	5~16
												16~18	5~17
												19~20	5~19
												When A=38, M5	When A=38, 5
13~15	5~13												
16~20	5~14												
21~25	5~15												
26~30	5~18												
26~30	5~17												



Part Number	T	A	E	G
LBPS25	T35	A48	E16	G15
LBPM20	T35	A38	E20	G5