



## 電鑄鑽石鑽管 / Electroplated Diamond Core Drills



■ 此系列產品主要使用於FRP、超硬磁磚、人造花崗岩、花崗岩、拋光石英磚、瓷器、大理石、陶器、赤土陶器、玻璃、石墨、石材等材料之鑽孔。

■ **Electroplated Diamond Core Drills** are used for drilling FRP, hard tiles, artificial granite, granite, quartz, porcelain, marble, ceramic, terra cotta ceramic, glass, graphite, & stone.

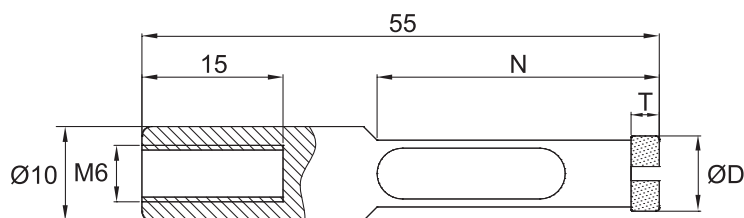

### 規格 / Specifications:

單位 / Unit : mm

編號 Order no.	ØD		T	N	粒度 Grit size	備註 Note
	mm	inch				
ESD-032	3.2	1/8"	10	25	#60	Solid drills
ECD-050	5.0	3/16"	3	30	#60	Core Drills
ECD-065	6.5	1/4"	3	30	#60	Core Drills
ECD-080	8	5/16"	3	30	#60	Core Drills
ECD-100	10	3/8"	3	30	#60	Core Drills
ECD-130	13	1/2"	3	30	#60	Core Drills
ECD-160	16	5/8"	3	35	#60	Core Drills
ECD-191	19.05	3/4"	3	35	#60	Core Drills
ECD-254	25.4	1"	3	35	#60	Core Drills

■ 標準粒度外，其他粒度請指明訂購。

■ Grit size in the above table is standard for that item, others are available upon request.